

THIS DRAWING IS UNPUBLISHED. RELEASED FOR PUBLICATION AUGUST, 2005.
 © COPYRIGHT 2005 BY TYCO ELECTRONICS CORPORATION. ALL RIGHTS RESERVED.

LOC	DIST	REVISIONS					
		P	LTR	DESCRIPTION	DATE	DWN	APVD
E	B	A		FIRST ISSUE	09AUG05	JMS	FWK

NOTES:

- 1 SINGLE PACK IN ACCORDANCE WITH AMP SPEC 107-3275
- 2 50 TRAY PACK IN ACCORDANCE WITH AMP SPEC 107-3275
- 3 Au PLATING OVER Ni PLATING OVER Cu PLATING
- 4 Ni PLATING OVER Cu PLATING
- 5 TIN PLATING
- 6 MOUNTING POSTS ARE OPTIONAL SEE TABLE FOR PART NUMBERS
- 7 RECOMMENDED SELF-TAPPING SCREW 221108-4
- 8. RECOMMENDED MOUNT NUT 1-1634816-0
- 9. RECOMMENDED LOCKWASHER 1-1634817-0
- 10. CHARACTERISTICS

FREQUENCY RANGE:	DC - 4GHz
NOMINAL IMPEDANCE:	50 OHMS
WORKING VOLTAGE:	500V RMS
INSULATION RESISTANCE:	5000 MOHMS
DIELECTRIC WITHSTAND VOLTAGE:	1500V RMS
CONTACT RESISTANCE:	
CENTRE CONTACT	1.5 mOHMS
OUTER CONTACT	0.2 mOHMS
- 11. MECHANICAL CHARACTERISTICS

DURABILITY:	50 CYCLES
-------------	-----------
- 12. FOR TECHNICAL DATA REFER TO YOUR LOCAL TYCO ELECTRONICS SALES OFFICE
- 13. ALL DIMENSIONS ARE NOMINAL FOR REFERENCE ONLY UNLESS OTHERWISE STATED

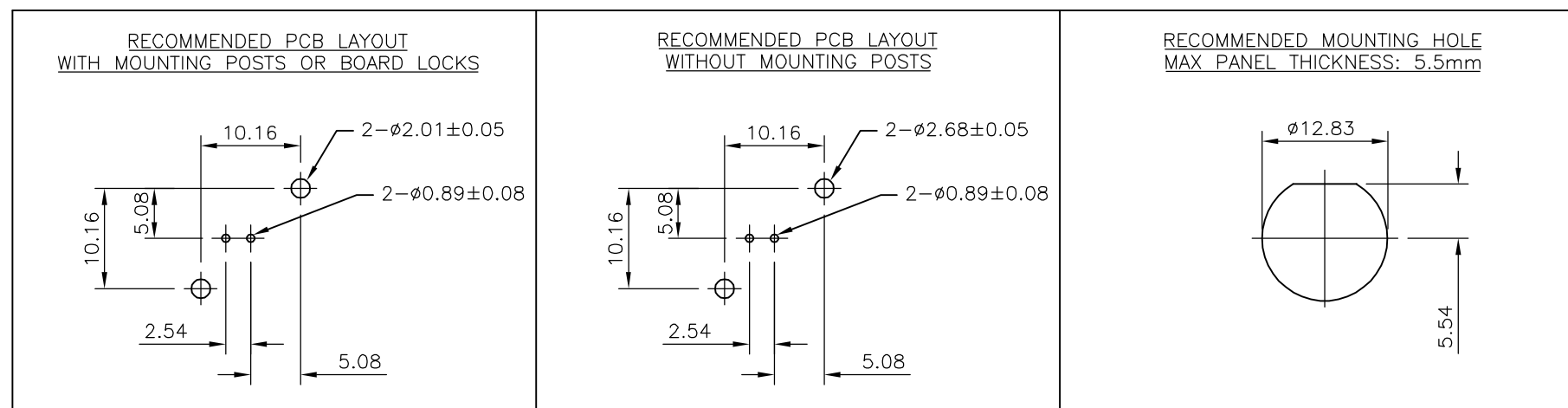
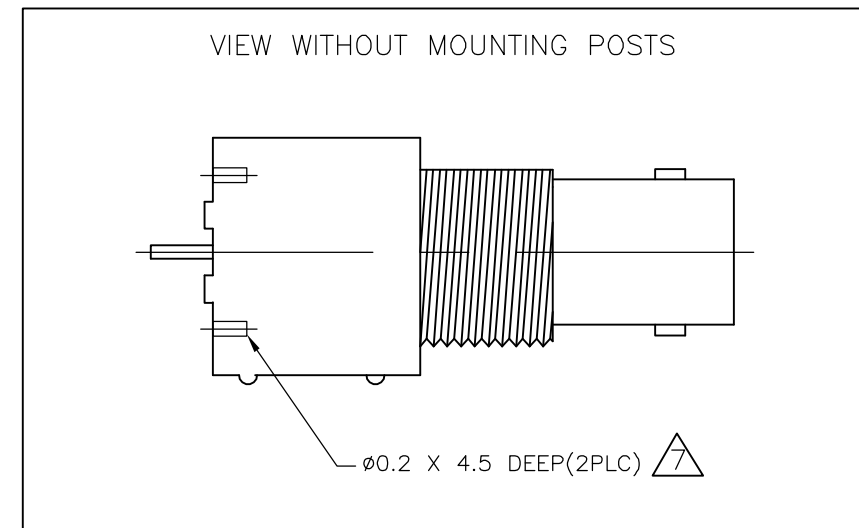
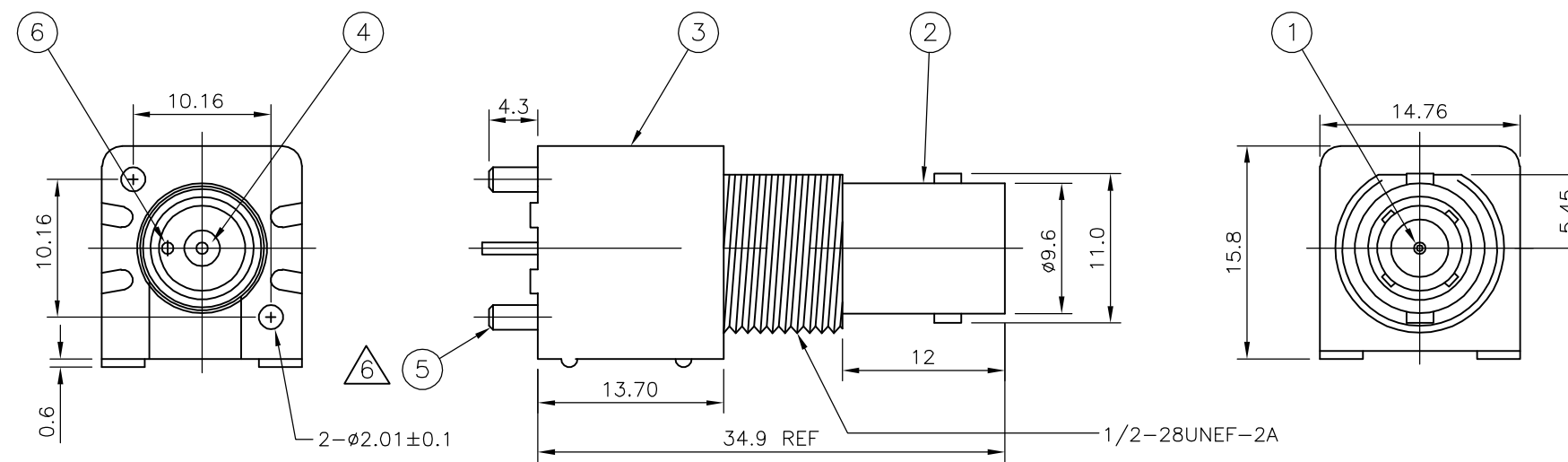

QTY	UNIT	QTY	UNIT	QTY	UNIT	QTY	UNIT	MATERIAL	DESCRIPTION	ITEM
1	1	1	1	1	1	1	1	BRASS	SOLDER TAIL	6
-	-	2	2	2	2	2	2	BRASS	MOUNTING POST	5
1	1	1	1	1	1	1	1	PE-606	INSULATOR	4
1	1	1	1	1	1	1	1	PBT BLACK	HOUSING	3
1	1	1	1	1	1	1	1	ZINC ALLOY	BODY	2
1	1	1	1	1	1	1	1	BRASS	CONTACT	1
6--1	1--1	6--0	1--0					MATERIAL	DESCRIPTION	ITEM

THIS DRAWING IS A CONTROLLED DOCUMENT.		DWN	J.SANDWELL	09AUG05	 Tyco Electronics Corporation Bideford, UK, EX39 4HE																	
DIMENSIONS: mm		CHK	S.PARLOW	09AUG05																		
TOLERANCES UNLESS OTHERWISE SPECIFIED		APVD	F.WHEELER-KING	09AUG05																		
<table border="0"> <tr><td>0 PLC</td><td>±</td><td>-</td></tr> <tr><td>1 PLC</td><td>±</td><td>-</td></tr> <tr><td>2 PLC</td><td>±</td><td>-</td></tr> <tr><td>3 PLC</td><td>±</td><td>-</td></tr> <tr><td>4 PLC</td><td>±</td><td>-</td></tr> <tr><td>ANGLES</td><td>±</td><td>-</td></tr> </table>		0 PLC	±	-		1 PLC	±	-	2 PLC	±	-	3 PLC	±	-	4 PLC	±	-	ANGLES	±	-	NAME	BNC STRAIGHT INSULATED PCB SOCKET
0 PLC	±	-																				
1 PLC	±	-																				
2 PLC	±	-																				
3 PLC	±	-																				
4 PLC	±	-																				
ANGLES	±	-																				
MATERIAL SEE TABLE		PRODUCT SPEC	108-3435		SIZE	A2																
FINISH SEE TABLE		APPLICATION SPEC	N/A		CAGE CODE	00779																
WEIGHT		-		DRAWING NO		C=1634505																
CUSTOMER DRAWING		SCALE		SHEET		1 OF 1																

1634505